

ADQUISICIÓN PISTONES ANILLAS GENERAC 9L ENTRE RIOS

| NRO       | REQUERIMIENTO   |             |       |       | OFERTA 1         |
|-----------|---|-------------|-------|-------|------------------|
| 1         | Cotización de ítems para MOTOR GENERAC 9L G26, Serial Number: 3011038313 y número de parte según requerimiento o número de parte actualizado. |             |       |       | CUMPLE/NO CUMPLE |
| 2         | DESCRIPCIÓN PIEZA   | N° PARTE    | CANT. | UNID. |                  |
| 2.1       | PISTON 114.16 ASSEMBLY NP:10000018229   | 10000018229 | 8     | KIT   | CUMPLE/NO CUMPLE |
| 2.2       | CONNECTING ROD. G9.0L. ASSEMBLY NP:10000002205  | 10000002205 | 1     | UN    | CUMPLE/NO CUMPLE |
| 2.3       | BEARING CON ROD LWR 56MM NP:A0001243732   | A0001243732 | 8     | UN    | CUMPLE/NO CUMPLE |
| 2.4       | BEARING CON ROD UPPR 56MM NP:A0001243733  | A0001243733 | 8     | UN    | CUMPLE/NO CUMPLE |
| 2.5       | IDLER FRONT END DRIVE NP: 10000007925   | 10000007925 | 1     | UN    | CUMPLE/NO CUMPLE |
| 2.6       | TIMING CHAIN NP:OH6974  | OH6974      | 1     | UN    | CUMPLE/NO CUMPLE |
| 2.7       | SPROCKET CAMSHAFT G9.0L NP:10000002210  | 10000002210 | 1     | UN    | CUMPLE/NO CUMPLE |
| 3         | Presentar documentación que los repuestos solicitados son adquiridos de fábrica o de algún distribuidor oficial de la marca.                  |             |       |       | CUMPLE/NO CUMPLE |
| 4         | DDP, Entregado y descargado en almacén Central Santa Cruz   |             |       |       | CUMPLE/NO CUMPLE |
| 5         | Plazo de Entrega Requerido: 60 días calendario.   |             |       |       | CUMPLE/NO CUMPLE |
| RESULTADO |   |             |       |       | HABILITADA       |

**GENERAC**

Section 1: Service Parts

9.0L Gaseous Engine (G26)  
Parts Manual

For  
Generators

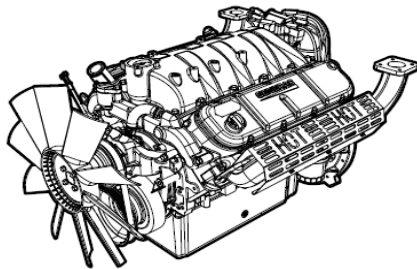

Engine Information

|              |           |       |  |               |             |   |
|--------------|-----------|-------|--|---------------|-------------|---|
| ENGINE SIZE: | 9.0 Liter | FUEL: | Natural Gas<br>Liquid Propane<br>Propane Vapor | Generac (G26) | ENGINE P/N: | 0L2475<br>0L2475A<br>A0000205573<br>10000030518 |
|--------------|-----------|-------|--|---------------|-------------|---|

NOTE: Grayed out parts, parts without item numbers, and parts marked "REFERENCE ONLY" will not be supplied.

Piston and Connecting Rod

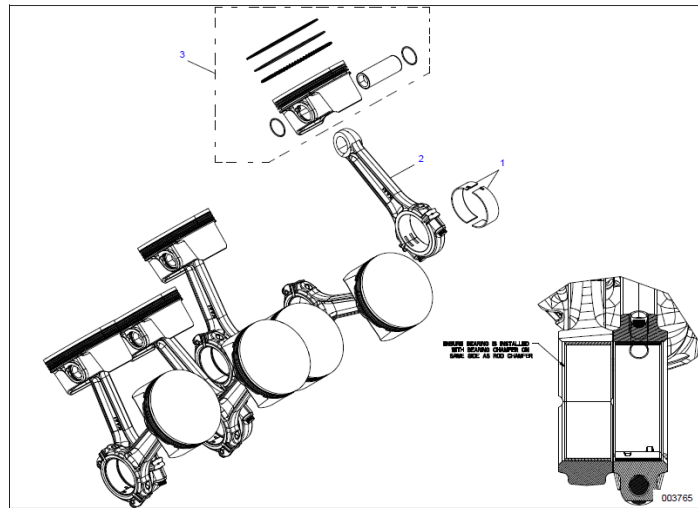

| Item | Part Number | Description                    | Qty. |
|------|-------------|--------------------------------|------|
| 1    | 0J5079      | BEARING, CONNECTING ROD NARROW | 8    |
| 2    | 10000002205 | CONNECTING ROD G9.0L ASSEMBLY  | 8    |
| 3    | 10000018229 | PISTON 114.16 ASSEMBLY         | 8    |

Search Results - Inventory with green check mark is available for expedited shipment

Items: 1 to 1 of 1

| Item Number  | Item Description              | MSLP     | Item Class |
|--|-------------------------------|----------|------------|
| 0J5079   | BEARING CONNECTING ROD NARROW | See Note | D9         |
| Note: Obsolete. Order both <a href="#">A0001243733</a> and <a href="#">A0001243732</a> |                               |          |            |